

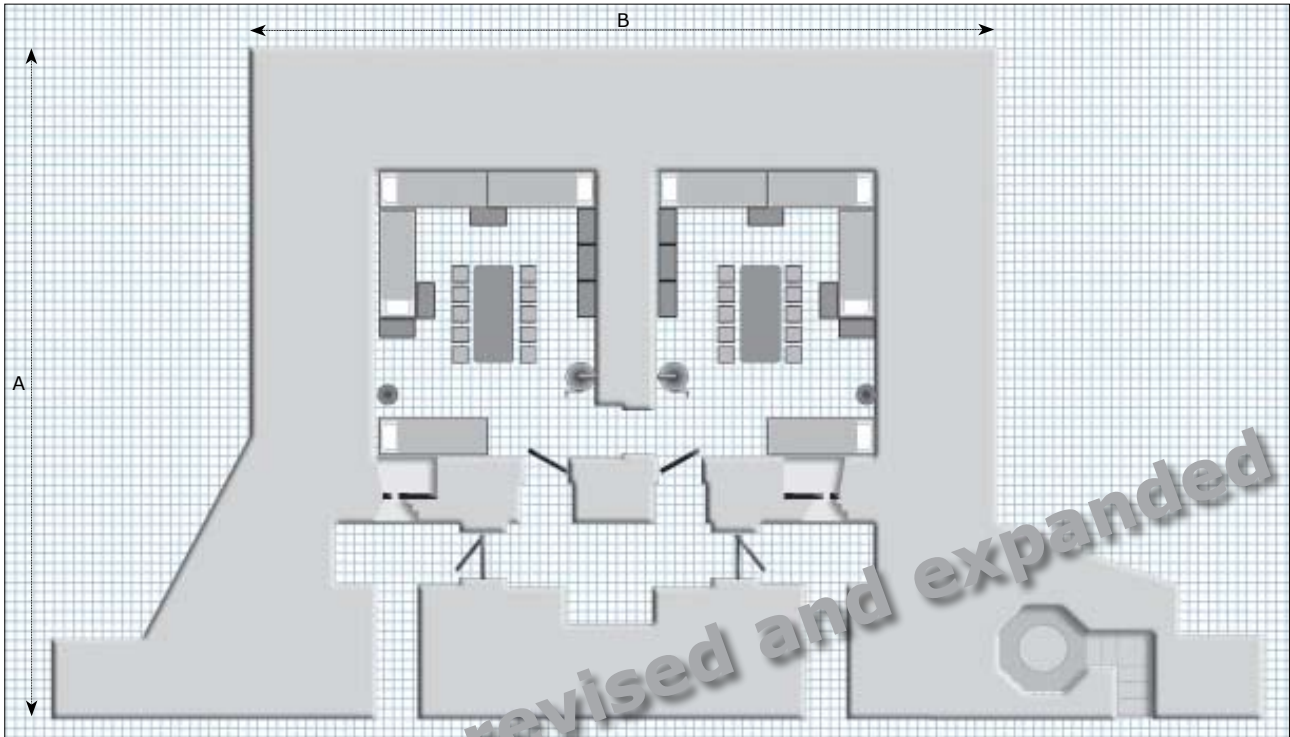

REGELBAU 622 DOBBELGRUPPEUNTERSTAND

TWIN GROUP BUNKER (20 MEN)



Technical data.

Size (a x b)	1150 cm x 1260 cm
Height approx:	500 cm
Concrete:	660 m ³
Reinforcement steel:	
Heating:	Festungssofen WT80
Ventilation:	Manual, with replacable filter

Bar- or wooden door	1
Machine gun	2
Panser door (3 cm thick)	3
Airlock	4
Bunks (10 per room)	5
Double closets	6
Ventilation	7
Oven for heating (gas proof)	8
Machinegun post (Tobruk)	9

The R622 was the home of two standard groups, each consisting of 10 men led by a corporal. Each group had its own room with an oven for heating and providing each group member with a bed, a closet and a stool at the table.

Along with the 621, this bunker is the most common Regelbau construction in Denmark

The bunker was cast from 660 m³ of steel-reinforced concrete with walls and ceiling two meters thick, providing protection against a direct hit from a 1000 lbs bomb or artillery shells up to 230 mm in caliber.

The bunker was sealed against war gasses, comprising an airlock, gas valves and a manually operated ventilation system.

Steel doors, 3 cm thick